

# QUANTOFIX® Phosphate

en

## Pack content:

1 aluminum container with 100 test strips  
 1 bottle PO<sub>4</sub><sup>3-</sup>-1                      1 measuring vessel with 5 mL mark  
 1 bottle PO<sub>4</sub><sup>3-</sup>-2                      1 test tube

## Measuring range:

Visually                                      Reflectometrically  
 3–100 mg/L PO<sub>4</sub><sup>3-</sup>                      3–80 mg/L PO<sub>4</sub><sup>3-</sup>

## Color gradation:

0 · 3 · 10 · 25 · 50 · 100 mg/L PO<sub>4</sub><sup>3-</sup>

## Safety precautions:

PO<sub>4</sub><sup>3-</sup>-1 contains nitric acid 5–20 % CAS 7697-37-2. DANGER Causes severe skin burns and eye damage. Do not breathe vapors. Wear protective gloves/eye protection. IF SWALLOWED: rinse mouth. Do NOT induce vomiting. IF ON SKIN (or hair): Remove/Take off immediately all contaminated clothing. Rinse skin with water/shower. IF INHALED: Remove to fresh air and keep at rest in a position comfortable for breathing. IF IN EYES: Rinse cautiously with water for several minutes. Remove contact lenses, if present and easy to do. Continue rinsing.

## General indications:

Remove only as many test strips as are required. Close the container immediately after removing a strip. Do not touch the test field.

## Instructions for use:

- Rinse the measuring vessel with the test solution and fill it to the 5 mL mark.
  - Add 5 drops PO<sub>4</sub><sup>3-</sup>-1 (nitric acid) to the sample.
  - Shake carefully.
  - Place the measuring vessel on the benchtop and remove the test tube from the package
  - Place the test tube into the cavity of the thermoformed mould.
  - Add 6 drops PO<sub>4</sub><sup>3-</sup>-2 to the test tube.
  - Insert the test strip into the sample.
  - Wait 15 seconds.
  - Shake off excess liquid.
  - Place test strip into the filled test tube.
  - Wait 15 seconds.
  - Shake off excess liquid.
  - Wait 60 seconds.
  - Compare with the color scale.
- If phosphate ions are present, the test field turns blue-green.

## Interferences:

This test only detects ortho-phosphate. Other phosphates, such as poly-, pyro- and metaphosphates have to be broken down from the total phosphate by digestion. Silicic acid (SiO<sub>2</sub>) contents above 10 mg/L reacts in the same way giving a blue colouration thus simulating a higher phosphate concentration. Larger concentrations of sulfide ions (S<sup>2-</sup>) cause a brown color of the test field, and smaller concentrations lead to low test results.

The following ions didn't interfere the determination:

< 1000 mg/L Ag<sup>+</sup>, Al<sup>3+</sup>, Cd<sup>2+</sup>, Co<sup>2+</sup>, Cr<sup>3+</sup>, Mg<sup>2+</sup>, Mn<sup>2+</sup>, NH<sub>4</sub><sup>+</sup>, Ni<sup>2+</sup>, Zn<sup>2+</sup>, Cl<sup>-</sup>, F<sup>-</sup>, NO<sub>2</sub><sup>-</sup>, SO<sub>4</sub><sup>2-</sup>, citrate, oxalate, tartrate, < 500 mg/L Ca<sup>2+</sup>, < 250 mg/L Pb<sup>2+</sup>, < 50 mg/L Cu<sup>2+</sup>, < 25 mg/L Fe<sup>3+</sup>, < 5 mg/L Fe<sup>2+</sup>, < 2 mg/L NO<sub>2</sub><sup>-</sup>.  
 Conversion factors: 1,0 mg PO<sub>4</sub><sup>3-</sup> = 0,75 mg P<sub>2</sub>O<sub>5</sub> = 0,33 mg P.

## Disposal:

The used analysis specimens can be flushed down the drain with tap water and channeled off to the local sewage treatment works. Used test strips can be disposed in household waste.

## Storage:

Avoid exposing the strips to sunlight and moisture. Keep container cool and dry (storage temperature not above +30 °C).  
 If correctly stored, the test strips may be used until the use-by-date printed on the packaging.

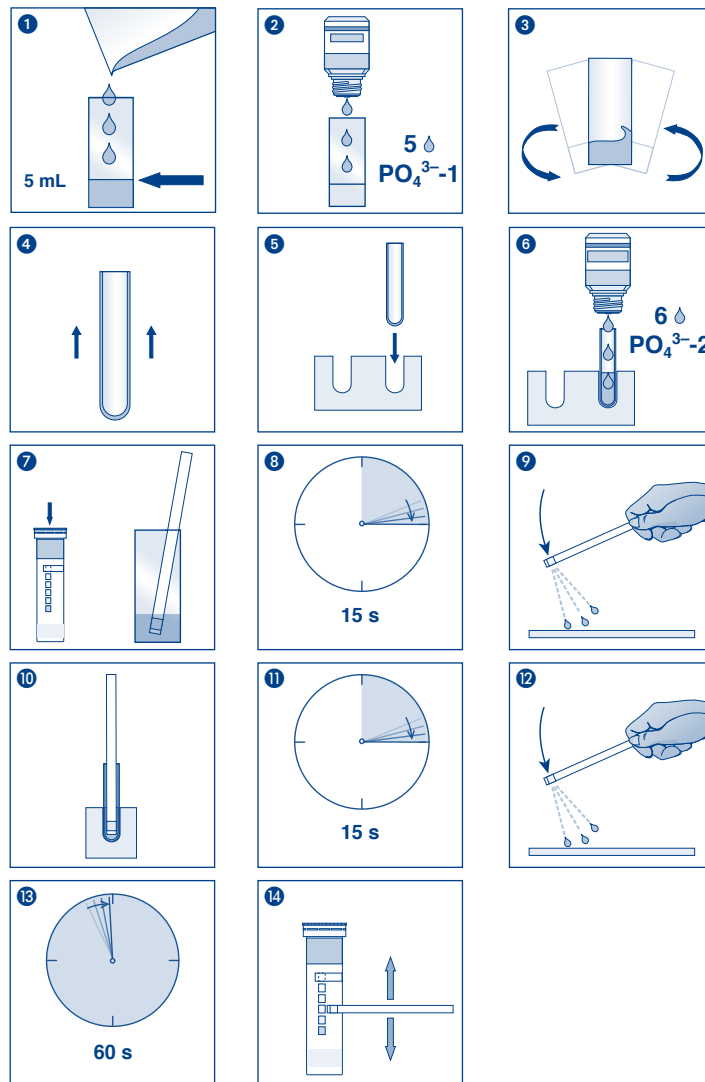

<b>REF</b>	Artikelnummer / Item number / Référence produit / Referencia / Artikelnummer / Numero di catalogo / Numer artykułu	<b>LOT</b>	Chargencode / Batch identification / Numéro de lot / Código de lote / Productienummer / Codice del lotto / Numer partii
	Achtung! / Warning! / Attention! / ¡Atención! / Let op! / Attenzione! / Uwaga!		Verwendbar bis / Use by / À utiliser avant / Fecha de caducidad / Te gebruiken tot / Utilizzare entro (anno / mese) / Przydatność do użycia
	Temperaturbegrenzung / Permitted storage temperature range / Limites de température / Limites de temperatura / Temperaturbegrenzung / Limite de temperatura / Ograniczenie temperatury		Trocken aufbewahren / Store in a dry place / Conserver au sec / Mantener seco / Op een droge plaats bewaren / Mantenere asciutto / Przechowywać w suchym miejscu
	Gebrauchsanweisung beachten / Please read instructions for use / Respected les instructions d'utilisation / Obsérvense las instrucciones de uso / Lees de bijsluit / Consultare le istruzioni per l'uso / Przestrzegać instrukcję użycia		Packung geschlossen halten / Keep container closed / Refermer la boîte / Mantenga el envase cerrado / Verpakking gesloten houden / Conservare la confezione chiusa / Przechowywać pojemnik szczelnie zamknięty
	Ausreichend für <n> Prüfungen / Contains sufficient for <n> tests / Contenu suffisant pour <n> tests / Contenido suficiente para <n> tests / Voldoende voor <n> tests / Contenuto sufficiente per <n> test / Wystarczająco dla kontroli <n>		

Rev 2016-08 A007878/913 20/0863